

WATER SHUTOFF MAP

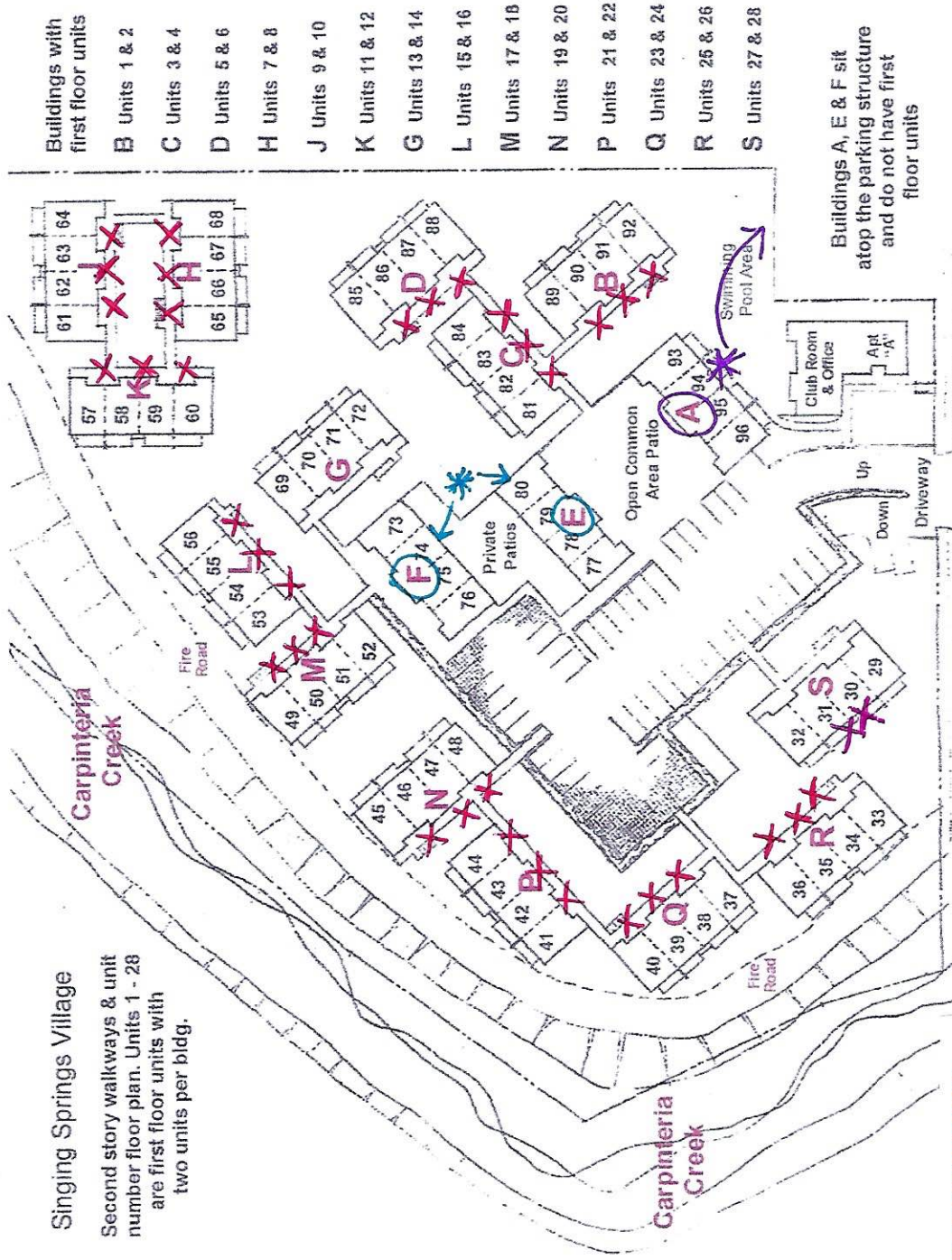

Singing Springs Village

Second story walkways & unit number floor plan. Units 1 - 28 are first floor units with two units per bldg.

Buildings with first floor units

B Units 1 & 2

C Units 3 & 4

D Units 5 & 6

H Units 7 & 8

J Units 9 & 10

K Units 11 & 12

G Units 13 & 14

L Units 15 & 16

M Units 17 & 18

N Units 19 & 20

P Units 21 & 22

Q Units 23 & 24

R Units 25 & 26

S Units 27 & 28

Buildings A, E & F sit atop the parking structure and do not have first floor units

5455 8th Street

*** WATER SHUTOFF VALVES FOR BUILDINGS "E" & "F" ARE LOCATED INSIDE LOCKED MAINTENANCE ROOM INSIDE LAUNDRY ROOM. KEY NEEDED TO OPEN MAINTENANCE ROOM. THE SHUTOFF LOCATED OUTSIDE OF LAUNDRY ROOM WILL SHUT OFF TO BOTH BUILDINGS AND THE LAUNDRY ROOM. ONLY USE IN AN EMERGENCY!**

*** WATER SHUTOFF VALVES FOR ALL 3 STORY BUILDINGS, EXCEPT FOR "S" ARE LOCATED AT THE FRONT OF EACH BUILDING. ALL 3 VALVES NEED TO BE TURNED OFF.**

*** WATER SHUTOFF VALVES FOR BUILDING "S" ARE LOCATED ON EACH OF THE TWO LOWER PATIOS ON THE BACKSIDE OF THE BUILDING.**

*** WATER SHUTOFF VALVE FOR BUILDING "A" IS LOCATED IN POOL EQUIPMENT AREA. A KEY IS NEEDED TO ACCESS.**